

SMT Power Inductor

SISN63 Type

Features

- RoHS compliant.
- Low profile (4.0mm max. height), SMD type.
- Unshielded, suitable for high density mounting.
- High energy storage and low DCR.
- Provided with embossed carrier tape packing.
- Ideal for power source circuits, DC-DC converter, DC-AC inverters inductor application.
- In addition to the standard versions shown here, customized inductors are available to meet your exact requirements.



Mechanical Dimension:

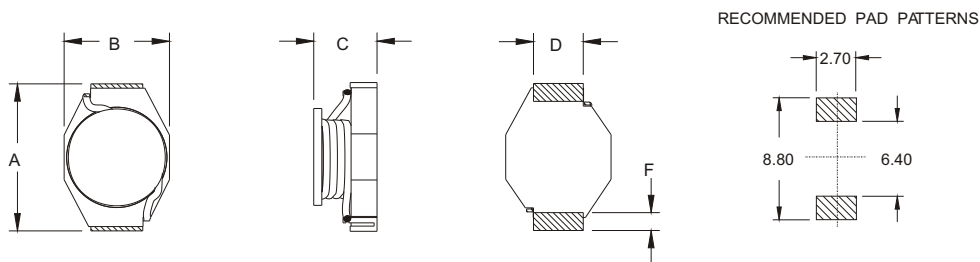

UNIT:mm/inch
 A = 8.60 ± 0.254 / 0.339 ± 0.010
 B = 5.84 ± 0.254 / 0.230 ± 0.010
 C = 4.00 / 0.157 Max.
 D = 2.50 ± 0.254 / 0.098 ± 0.010
 E = 1.50 ± 0.30 / 0.059 ± 0.012
 F = 0.80 / 0.032 (REF)

Electrical Characteristics: 25°C: 100KHz, 0.1V

| PART NO. | L ¹ (uH) | DCR (Ω)MAX | Isat ² (Adc) |
|------------|------------------------|---------------|----------------------------|
| SISN63-0R5 | 0.6 | 0.010 | 7.50 |
| SISN63-1R0 | 1.0 | 0.017 | 5.00 |
| SISN63-2R2 | 2.2 | 0.035 | 3.20 |
| SISN63-3R3 | 3.3 | 0.038 | 3.20 |
| SISN63-4R0 | 4.0 | 0.040 | 3.00 |
| SISN63-4R7 | 4.7 | 0.054 | 2.30 |
| SISN63-100 | 10.0 | 0.111 | 1.60 |
| SISN63-150 | 15.0 | 0.170 | 1.30 |
| SISN63-220 | 22.0 | 0.250 | 1.00 |
| SISN63-330 | 33.0 | 0.350 | 0.90 |
| SISN63-470 | 47.0 | 0.470 | 0.75 |

1. Tolerance of inductance : ±20%.
2. Isat is the DC current which cause the inductance drop less than 10% of its nominal inductance without current.
3. Operating temperature: -20°C to 105°C (including self-temperature rise).



DELTA ELECTRONICS, INC.

(TAOYUAN PLANT CPBG) 252, SAN YING ROAD, KUEISAN INDUSTRIAL ZONE, TAOYUAN SHIEN, 333, TAIWAN, R.O.C.

TEL: 886-3-3591968; FAX: 886-3-3591991

<http://www.deltawww.com>